

STAGE 1

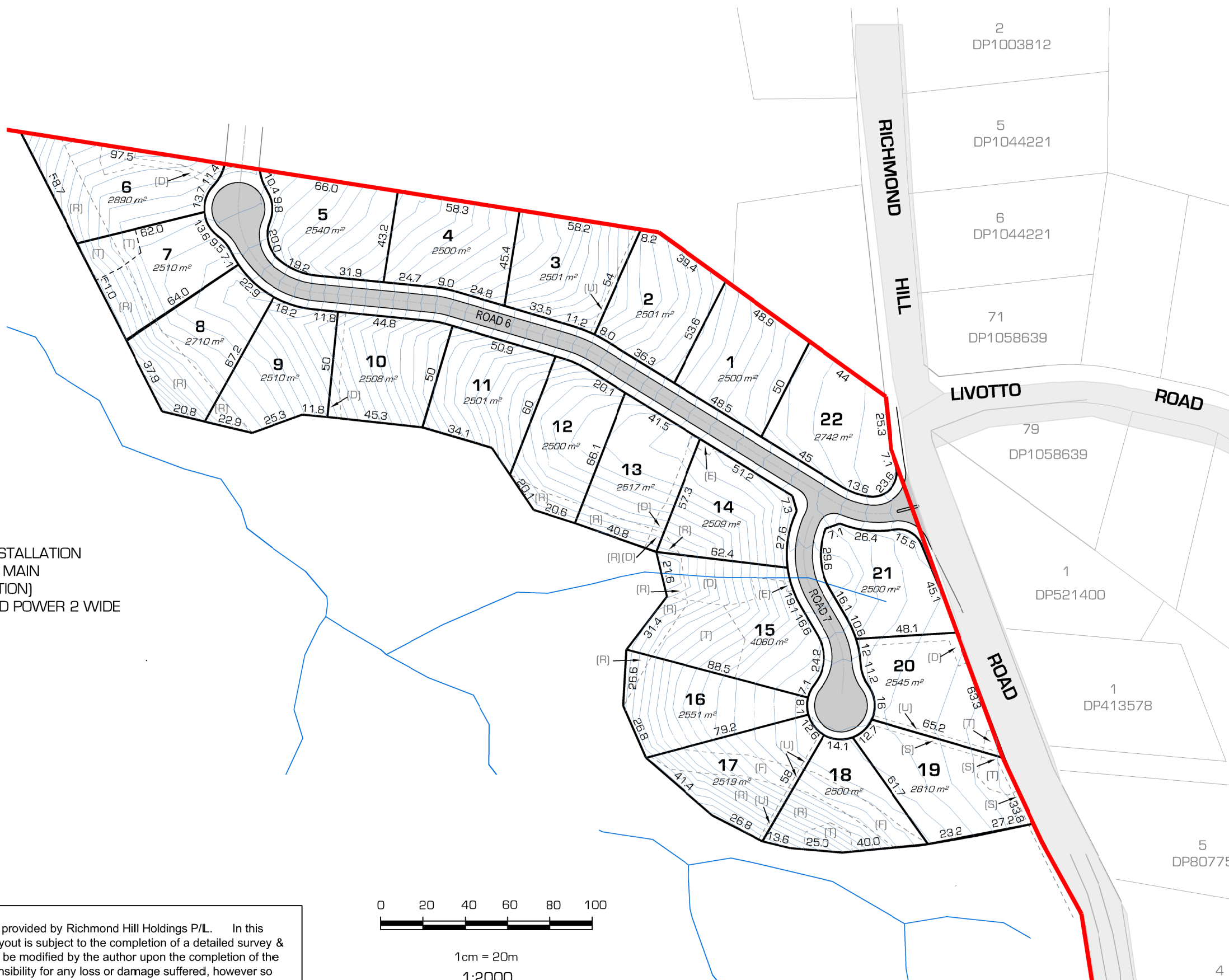

- (D) EASEMENT TO DRAIN WATER
- (E) EASEMENT FOR ELECTRICAL INSTALLATION
- (S) EASEMENT FOR SEWER RISING MAIN
- (T) NO BUILD ZONE (TREE PROTECTION)
- (U) EASEMENT FOR UNDERGROUND POWER 2 WIDE
- (R) NO BUILD ZONE
- (F) FOOTING INVESTIGATION AREA

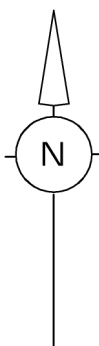

LEGEND

- SITE BOUNDARY
- PROPOSED LOT BOUNDARY

NOTE:
 This preliminary layout has been completed in accordance with the instructions provided by Richmond Hill Holdings P/L. In this respect preliminary desktop data has been used to form this layout. The final layout is subject to the completion of a detailed survey & engineering plans. Accordingly, the conclusions reached within this report may be modified by the author upon the completion of the final design plans & site inspection. Newton Denny Chapelle accepts no responsibility for any loss or damage suffered, however so arising, to any person or corporation who may use or rely on this report.

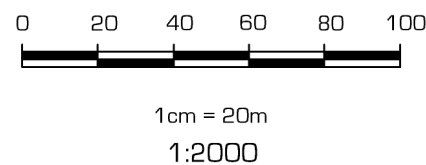

4

REV	DATE	AMENDMENT
A		
B		
C		
D		
E		

SOURCE PLAN: N/A
 k:\jobs\2004\04652 - pineapple rd\stage 1\planning\planning plans\ndc plans\cad files\stage 1 - sales plan.dwg - stage 1 - sales plan



NBS
Newton Denny Chapelle
 Surveyors Planners Engineers
 Email: office@newtondennychapelle.com.au
 LISMORE 31 Carrington St. Lismore 2480 PH: 6622 1011
 CASINO 100 Barker St. Casino 2470 PH: 6662 5000
 ABN: 86 220 045 469

SALES PLAN - STAGE 1

CLIENT: RICHMOND HILL HOLDINGS P/L
 Lot 11, 12 & 13 DP 810542 &
 Lot 1 DP 1136812
 LOCATION: PINEAPPLE ROAD
 GOONELLABAH NSW
 DATE: 21.03.17 REF: 04/652
 SCALE: 1:2000 @ A3 DRAWN: BK

© NEWTON DENNY CHAPELLE